

AKASO

EK7000 PRO

A C T I O N C A M E R A



USER MANUAL

V6.2

Content

What's in the Box	01	>>
Your EK7000 Pro	02	>>
Getting Started	04	>>
Overview of Modes	07	>>
Customizing Your EK7000 Pro	10	>>
Connecting to the AKASO GO App	16	>>
Transferring Your Content	17	>>
Playing Back Your Content	18	>>
Deleting Your Content	19	>>
Reformatting Your Memory Card	20	>>
Maintaining Your Camera	21	>>
Maximizing Battery Life	22	>>
Battery Storage and Operation	23	>>
Remote	24	>>
Mounting Your Camera	28	>>
Contact Us	30	>>

What's in the Box



EK7000 Pro
x 1



Waterproof
Housing x 1



Battery Charger
x 1



Battery
x 2



USB Cable
x 1



Remote Control
x 1



Remote Control
Strap x 1



Protective
Backdoor x 1



Clip
x 1



Clip 2
x 1



Buckle Mount
x1



J-Hook Mount
x1



E Mount
x1



C Mount
x1



D Mount
x1



F Mount
x1



A Mount
x1



H Mount
x 1



Spanner
x 1



Helmet Mount
x 2



Binden
x 4



Tether
x 5



Lens Cloth
x 1



Double-Sided
Adhesive Tape x 2



Quick Start
Guide x 1



Your EK7000 Pro

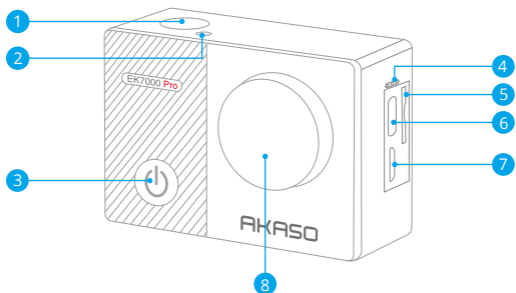

- ① Shutter / OK Button
- ② Wifi Indicator
- ③ Power / Mode / Exit Button
- ④ Microphone
- ⑤ Memory Card Slot
- ⑥ USB / External Mic Port
- ⑦ Micro HDMI Port
- ⑧ Lens



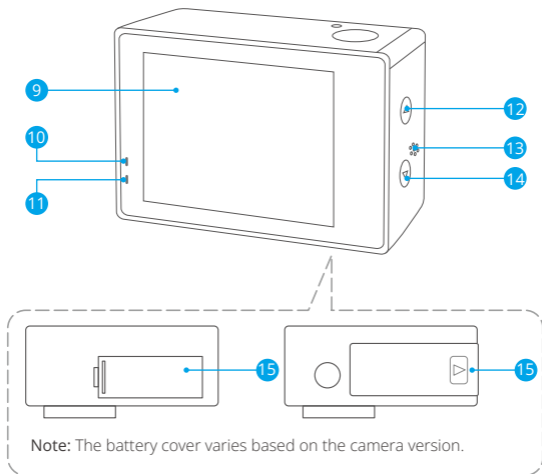

- 9 Touch Screen
- 10 Working Indicator
- 11 Charging Indicator
- 12 Up / Playback Button
- 13 Speaker
- 14 Down / Wifi / Settings Button
- 15 Battery Cover

Note: If you plan a deep dive, equip your camera with the waterproof housing to prevent it from getting soaked. But the camera will not record sound when it's in the housing.

Getting Started

Welcome to your new EK7000 Pro. To capture video and photos, you will need a memory card (sold separately).

Using Memory Cards

Use brand name memory cards that meet these requirements:

- Class 10 or UHS-I rating
- Capacity up to 256GB (FAT32)

Note:

1. When the camera is turned on for the first time or reset, the language settings page will pop up. Please set the system language before using the camera.
2. Please format the memory card first in this camera before using. To keep your memory card in good condition, reformat it on a regular basis. Reformatting erases all of your content, so be sure to offload your photos and videos first.
3. Memory cards larger than the specified maximum capacity can cause issues like non-recognition or even camera malfunctions like unresponsiveness or firmware failure.

Installing the Memory Card

First locate the memory card slot, then insert the memory card with the label facing the battery department. To remove the card, simply press it into the slot with your fingernail, and it will then pop out.

Note: Be sure to turn off the camera before installation.

Installing the Battery

Press the buckle of the battery cover to open it, then place the battery into its slot and close the battery cover. To remove the battery, pull the battery strip.



Charging the Camera

Locate the USB power port, and connect the camera to a USB adapter or computer using the USB cable. The charging indicator will be flashing red while charging, and black out when fully charged. Once fully charged, disconnect the cable.

Tip: Please fully charge the camera before first use; you can also charge the battery separately using the included battery charger; the camera can be fully charged in 1 hour and records 4K videos for up to 105 minutes; the actual battery life may vary based on the environment and usage.

Powering on or off

To power on: While the camera is off, press and hold the Power button for 3 seconds to turn it on. Once the display screen shows camera information and the working indicator turns on, you'll know that your camera is powered on.

To power off: While the camera is on, press and hold the Power button for 3 seconds to turn it off. The working indicator will also turn off.

Turning Wifi on or off

To turn on: On the preview screen, press and hold the Wifi button to turn on Wifi. You can also tap the Wifi icon in the mode menu to turn on Wifi.

To turn off: On the Wifi screen, press the Wifi button to turn off Wifi.

Switching Modes

To switch mode: On the preview screen, press the Mode button to switch modes. Alternatively, enter the mode menu and select a desired from the available options.

To exit mode: Press the Mode button to exit the current mode.

Zooming in or out

On the preview screen, tap the "+" or "-" icon on the screen to adjust the zoom level. Each tap will incrementally zoom in or out by 0.5x. The EK7000 Pro action camera supports up to 5x zoom.

Entering the Settings Screen

On the preview screen, press the Down button or tap the Settings icon in the bottom right corner to enter the camera's settings screen.

Using the Shutter Button

In Photo or Video mode, press the Shutter button to capture photos or start video recording. To stop recording in Video mode, press the Shutter button again.

Entering the Playback Screen

On the preview screen, press the Up button or tap the Playback icon in the bottom left corner to enter the playback screen.

Overview of Modes

The camera boasts 6 modes: Video, Photo, Burst Photo, Time Lapse Video, Time Lapse Photo, and Wifi.

On the preview screen, press the Mode button to switch modes. Alternatively, tap the mode icon at the bottom to access the mode menu screen for mode switching.

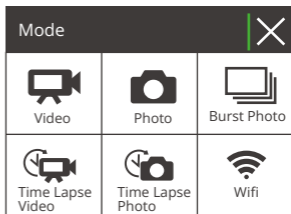
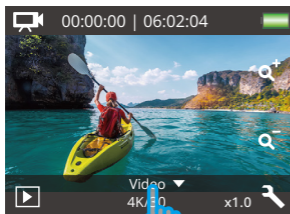

Video Mode

The camera is in Video mode by default when turned on.

In this mode, press the Shutter button to record normal video at the preset resolution and frame rate.

Press the Shutter button again to stop recording.

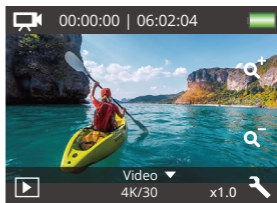
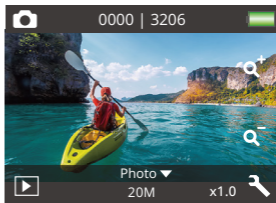

Photo Mode

On the preview screen, press the Mode button once to switch to Photo Mode.

In this mode, press the Shutter button to take a photo at the preset photo resolution.



Burst Photo Mode

On the preview screen, press the Mode button twice to switch to Burst Photo Mode.

In this mode, press the Shutter button to take 3 photos per second.

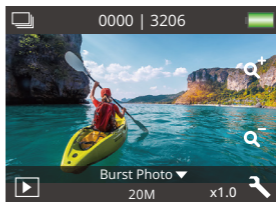

Time Lapse Video Mode

On the preview screen, press the Mode button 3 times to switch to Time Lapse Video Mode.

In this mode, press the Shutter button to create video clips by capturing frames at the set interval.

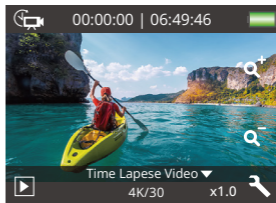

Time Lapse Photo Mode

On the preview screen, press the Mode button several times to switch to Time Lapse Photo Mode.

In this mode, press the Shutter button, and the camera captures a series of photos at the set self-timer interval then combines them into a video.

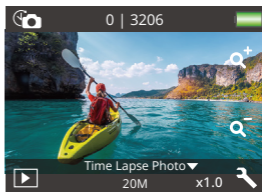

Wifi Mode

When Wifi is turned on, the camera will enter Wifi mode and display the Wifi information.

Note: The camera's Wifi will automatically turn off if not connected to the AKASO GO app within 3 minutes. Re-activate it to reconnect to the app.

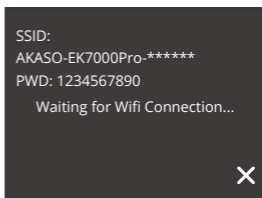

Customizing Your EK7000 Pro

Video & Photo Settings

On the preview screen, press the Down button or tap the Settings icon in the bottom right corner to access the camera's settings screen. From there, you're free to configure the video & photo and system settings.

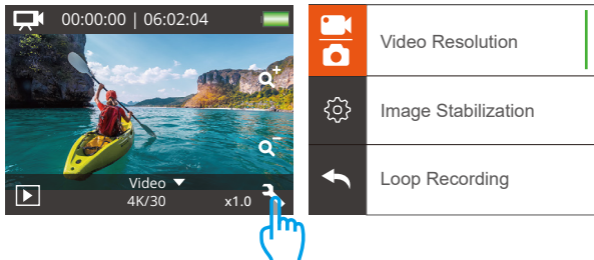

1. Video Resolution

4K 30fps/2.7K 30fps/1080P 60fps/1080P 30fps/720P 120fps/720P 60fps (Default setting: 4K 30fps)

Configure the resolution settings before recording videos. The camera records up to 4K 30fps videos.

Note: Capturing high-resolution or high-fps videos in warm environments can cause the camera to heat up and consume more power.

2. Image Stabilization

Off / On (Default setting: Off)

Image Stabilization can efficiently minimize the lens shakes, resulting in smooth and clear videos. This feature is ideal for capturing scenes involving activities like riding, skating, and handheld use.



3. Loop Recording

Off / 1 Min / 3 Min / 5 Min (Default setting: Off)

This option allows you to set the video length before recording loop videos. For instance, if you set "Loop Recording" to "3min", the camera will save video files every 3 minutes. When the memory is full, new video files will overwrite the old ones to ensure continuous recording.

4. Time Lapse Video

Off / 1 Sec / 3 Sec / 5 Sec / 10 Sec / 30 Sec / 60 Sec (Default setting: 5 Sec)

Time Lapse Video creates video from frames captured at specific intervals. This option enables you to set how often your camera captures a frame of video.

Note: Time lapse videos are captured without audio.

5. Date Stamp

Off/Date/Date&Time (Default setting: Date)

With Date Stamp enabled, the camera will add a watermark to your videos or photos per your setting.

Note: Date Stamp is disabled when recording time lapse video or when Image Stabilization is enabled.

6. Exposure Value

-2.0 / -1.7 / -1.3 / -1.0 / -0.7 / -0.3 / 0.0 / +0.3 / +0.7 / +1.0 / +1.3 / +1.7 / +2.0
(Default setting: 0.0.)

By default, your camera utilizes intelligent analysis of the entire image to determine the optimal exposure level. However, with the remarkable Exposure feature, you now have the ability to designate a specific area that takes priority in determining the ideal exposure. This invaluable setting proves particularly useful when capturing shots where critical regions may otherwise suffer from over or underexposure. As you make adjustments, the display promptly showcases the immediate impact on your image, guaranteeing that you never miss a moment.

Rest assured that should you switch modes, the camera seamlessly reverts back to utilizing the complete scene for precise exposure calculation.

7. Photo Resolution

20MP/16MP/14MP/12MP/8MP/5MP/4MP (Default setting: 20MP)

This camera is capable of capturing 20MP photos, with higher resolution offering greater clarity and detail due to the increased number of pixels. However, higher resolution photo also results in larger file sizes.

8. Burst Photo

Off / 3 Photos (Default setting: Off)

Burst Photo lets you take up to 3 photos in 1 second, making it perfect for capturing fast-moving activities.

9. Self-timer

2 Sec / 3 Sec / 5 Sec / 10 Sec / 30 Sec / 60 Sec (Default setting: 5 Sec)

Set the interval at which the camera captures photos in Time Lapse Photo mode.

10. Time Lapse Photo

Off / On (Default setting: On)

With Time Lapse Photo enabled, this camera captures a series of time lapse photos at the set Self-timer interval and compiles them into a video. When disabled, the camera will capture a single photo instead.

System Settings

1. Special Effect

Normal / Black & White / Sepia / Negative / Warm / Cold / Red / Green / Blue
(Default setting: Normal)

Choose an ideal special effect for your photos or videos to enhance their appeal.

Note: Special Effect and Diving Mode can't be used at the same time. Be sure to set special effect to "Normal" to avoid color cast in your images.

2. Angle

Super Wide/Wide/Medium/Narrow (Default setting: Super Wide)

The angle refers to how much of the scene can be captured through the camera lens. Wide angle captures the largest amount of the scene, while Narrow angle captures the least.

3. Microphone

Built-in/External (Default setting: Built-in)

You have the option to select either a built-in microphone or an external one. To use an external microphone for better sound quality, select the "External" option first. Then, connect a compatible external microphone to the camera's USB port.

Tip: If you do not wish to use an external microphone, be sure to select the "Built-in" option in case the camera does not properly record sound during video recording.

4. Diving Mode

Off/Swimming/Snorkeling/Scuba/Custom (Default setting: Off)

Configure or turn off this setting. Diving Mode compensates for the blue or green color cast caused by water, ensuring more accurate and natural colors in your underwater footage, so it's ideal for underwater capture.

Tip:

① You can select "Custom" to configure color temperature settings, but there may

be color cast with Custom enabled. Options include 2800K, 3200K, 4000K, 4500K, 5000K, 5500K, 6000K, 6500K, 7000K, 7500K.

- ② Diving Mode and Special Effect can't be used at the same time. Be sure to set special effect to "Normal" to avoid color cast in your images.

5. Power Frequency

50Hz/60Hz/Auto (Default setting: Auto)

Choose the line frequency at which the video is recorded.

6. Language

English/简体中文/繁体中文/Italiano/Español/Português/Deutsch/Dutch/Français/日本語/한국어/Русский/Bahasa Indonesia/PolSKI/Romanina/Dansk/Svensk/Nederlands/Türk/ไทย/Magyar/Suomi/Norsk/Български (Default setting: English)

Choose the desired system language for your camera interface.

7. Date & Time

YY/MM/DD, HH/MM/SS

Manually set the camera's date and time according to your local time.

Tip: The date and time will also be automatically updated when you connect your camera to the AKASO GO app.

8. Sounds

Shutter: Off/On Beep: Off/On Boot-up: Off / On Volume: 0/1/2/3
(Default setting: On)

You can turn the shutter, beep, and boot-up sounds on or off, or adjust the camera's volume.

9. Upside Down

Off/On (Default setting: Off)

This setting determines the orientation of your video or photos to help you

prevent upside-down footage.

Note: The user interface will be upside-down when Upside Down is enabled.

10. Screen Saver

Off / 1 Min / 3 Min / 5 Min (Default setting: 1 Min)

You can determine when the camera's display should go dormant to conserve battery. If you need the screen to turn back on, just tap it or press any button.

11. Auto Power Off

Off / 1 Min / 3 Min / 5 Min (Default setting: 3 Min)

Set the duration of inactivity after which the camera automatically powers off. If not operated within the chosen duration, the camera will shut down.

12. Format

No/Yes (Default setting: No)

To keep your memory card in good condition, reformat it on a regular basis. To keep your memory card in good condition, reformat it on a regular basis. Reformatting erases all of your content, so be sure to offload your photos and videos first.

13. Reset

No/Yes (Default setting: No)

This option resets all settings to their default values.

14. Version

Brand: AKASO

Model: EK7000 Pro

Version: XXXXXXXX

You can check the model, version and updated time of your EK7000 Pro.

Connecting to the AKASO GO App

To connect your camera to the AKASO GO app, please download this app from the App Store or Google Play to your smartphone first. When your camera is connected to the AKASO GO app, you can control it to capture, or change its settings using your phone. You can also live preview, playback, download, edit, and share videos via this app. Please follow the instructions below to connect your camera to the AKASO GO app.

1. Turn on the camera, press and hold the Wifi button to turn on Wifi. The camera will enter Wifi mode and display the Wifi information in 3 seconds.
2. Enter your phone's Wifi settings page, find the Wifi named "EK7000 Pro" in the list and tap on it, then enter the password 1234567890 for connection.

Warm tip: Once the camera Wifi is connected, a "No Internet Connection" or "Weak Security" notification will appear since the phone's data is paused. You can ignore it and continue the app connection.

3. Open the AKASO GO app on your smartphone, then tap "Device" → "Add Device" to choose EK7000 Pro from the options for connection.
4. Tick "The above operation has been confirmed", and tap "Live Preview". Your camera will be connected to the AKASO GO app in seconds.



Transferring Your Content

Transferring Your Content to a Computer

You can transfer your content to a computer via a USB cable or a card reader (sold separately). To transfer files to your computer via a USB cable, connect your camera to the computer's USB port using the USB cable. When prompted, select "USB Storage" as your connection preference. To transfer files to the computer using a card reader, insert a memory card into the card reader, then connect the reader to your computer's USB port. After successful transmission, you can transfer the files to your computer or delete selected files using File Explorer.

Downloading Your Content to a Smartphone

1. Open the AKASO GO app, then connect it to the camera.
2. Tap the Album icon in the bottom left corner to view all the photos and videos captured by the camera.
3. Tap the Select icon in the upper right corner to select the video or photo you want to download, then tap the Download icon in the bottom right corner. Patiently wait for the download process to complete. The file will be successfully saved to your phone's photo album.

Note:

1. Please do not alter Wifi settings or disconnect from the app during the download progress.
2. If you cannot download videos or photos to your iPhone via the app, please enter your phone's Settings page → Privacy → Photos, find "AKASO GO", and select "All photos".
3. iPhone does not allow you to download 4K or 2.7K videos via the app. Please transfer these videos to your computer.



Playing Back Your Content

You can play back your content on the camera, your computer, TV, smartphone or tablet. You can also play back content by inserting the memory card directly into a device, such as a computer or a compatible TV. With this method, playback resolution depends on the resolution of the device and its ability to play back that resolution.

Viewing Your Videos or Photos on the EK7000 Pro

- 1 Turn on your camera.
2. Tap the Playback icon in the bottom left corner to enter playback mode.
3. Tap the video or photo icon to access your video or photo files.
4. Tap the Forward or Backward icon to select the file you want to playback.
5. Tap the Playback icon on the selected file for playback.
6. To exit the video or photo file, tap return icon .
7. To exit the playback screen, tap the "X" icon in the upper right corner.

Note: If your memory card contains a lot of content, it might take one minute to load.

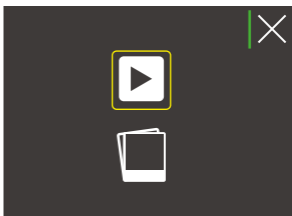
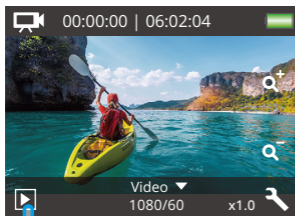

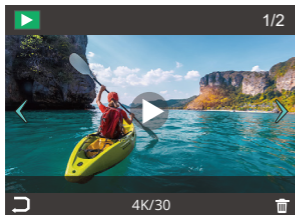

Deleting Your Content

Deleting Your Videos or Photos on the EK7000 Pro

1. Enter Playback mode.
2. Tap the video or photo icon to access your video or photo files.
3. Tap the Forward or Backward icon to select the file you want to delete.
4. Tap the Delete icon. The screen shows "Delete this file? Yes/No".
5. Tap "Yes", the selected file will be deleted.



Reformatting Your Memory Card

To keep your memory card in good condition, reformat it on a regular basis. Reformatting erases all of your content, so be sure to offload your photos and videos first.

1. Turn on the camera.
2. Press the Down button or tap the Settings icon in the bottom right corner to enter the settings screen.
3. On this screen, press the Down button followed by the Shutter button or tap the Settings icon to enter the system settings screen.
4. Press the Down button or scroll down to locate the "Format" option.
5. Press the Shutter button or tap "Format" to enter the formatting screen. The screen shows "Format card? Yes / No".
6. Tap "Yes" or press the Shutter button to confirm.
7. The memory card is formatted successfully.



Maintaining Your Camera

Follow these guidelines to get the best performance from your camera:

1. For optimal audio performance, gently shake the camera or blow on the microphone to remove any debris from the microphone holes.
2. To clean the lens, use a soft, lint-free cloth to wipe it. Avoid inserting any foreign objects near the lens.
3. Do not touch the lens with your fingers.
4. Store the camera away from drops and bumps, as this may cause damage to the internal components.
5. Store the camera away from high temperatures and strong sunshine to protect it from damage.
6. Store the camera away from sharp objects and moisture-prone areas.



Maximizing Battery Life

A message appears on the touch display if the battery drops below 10%. If the battery reaches 0% while recording, the camera saves the file and powers off. To maximize battery life, follow these guidelines when possible:

1. Turn off the Wifi connection.
2. Capture video at lower resolutions and frame rates.
3. Use the Screen Saver setting.



Battery Storage and Operation

1. If storing for extended periods, maintain a battery charge of 50-60%. Charge every 3 months and discharge the battery every 6 months.
2. Do not store the battery with metal objects such as coins, keys, or necklaces. If the battery terminals come close to metal objects, a short circuit may cause fire.
3. Store the battery in dry areas, safe from potential physical damage caused by squeezing or collision.
4. Avoid using or storing the battery at high temperatures, such as in direct sunlight or a hot compartment. The battery will heat up, malfunction, or have its service life shortened in these conditions.
5. Avoid using or storing the battery in low-temperature environments, as this will shorten the battery life or cause it to malfunction.
6. Avoid environments with strong static or magnetic fields; these can compromise the battery's protective unit, posing safety risks.
7. If the battery emits an odor, overheats, changes color, gets distorted, or exhibits any anomalies, discontinue use and remove it immediately from the camera or the battery charger whether it is being used, charged, or stored.
8. Safely insulate used electrodes to prevent potential hazards.



Remote

When the camera is turned on, it will be automatically connected to the remote within 10 meters of distance. You can control the camera to take photos or record videos using the remote.

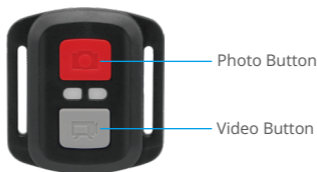

Note: The remote is splashproof only.

Video

To record video, first make sure the camera is in Video mode, then press the Video button. The camera's working indicator will be flashing during video recording. To stop recording, press the Video button again.

Photo

To capture a photo, first make sure the camera is in Photo mode, then press the Photo button. The camera will emit a shutter sound indicating the completion of the shot.



Burst Photo

To capture burst photos, first verify the camera is in Burst Photo mode, then press the Photo button. The camera will emit a shutter sound indicating the completion of the shot.

Time Lapse

To capture time lapse photos or videos, first verify the camera is in Time Lapse mode, then press the Photo or Video button.

Replacing the CR2032 battery of the remote

- (1) Use a screwdriver to remove the 4 screws on the back cover of the remote, allowing you to open it.



- (2) Remove another 4 screws on the remote's circuit board.



(3) Lift the circuit board and slide out the battery, as shown below.

Note: Avoid rotating the circuit board to prevent reversing the remote control buttons.



(4) Install the new battery, keeping the "+" pole facing up.

(5) Install all 4 screws back onto the circuit board.



(6) Install all 4 screws back into the cover.

⚠ WARNING

- **INGESTION HAZARD:** This product contains a button cell or coin battery.
- **DEATH** or serious injury can occur if ingested.
- A swallowed button cell or coin battery can cause **Internal Chemical Burns** in as little as **2 hours**.
- **KEEP** new and used batteries **OUT OF REACH of CHILDREN**
- **Seek immediate medical attention** if a battery is suspected to be swallowed or inserted inside any part of the body.



- a) Remove and immediately recycle or dispose of used batteries according to local regulations and keep away from children. Do NOT dispose of batteries in household trash or incinerate.
- b) Even used batteries may cause severe injury or death.
- c) Call a local poison control center for treatment information.
- d) CR2032
- e) DC 3V
- f) Non-rechargeable batteries are not to be recharged.
- g) Do not force discharge, recharge, disassemble, heat above (manufacturer's specified temperature rating 60°C) or incinerate. Doing so may result in injury due to venting, leakage or explosion resulting in chemical burns.
- h) Ensure the batteries are installed correctly according to polarity (+ and -).

Do not mix old and new batteries, different brands or types of batteries, such as alkaline, carbon-zinc, or rechargeable batteries.

Remove and immediately recycle or dispose of batteries from equipment not used for an extended period of time according to local regulations.

Always completely secure the battery compartment. If the battery compartment does not close securely, stop using the product, remove the batteries, and keep them away from children.

Mounting Your Camera

Attach your camera to helmets, gear and equipment.

Note: The camera is not waterproof. Be sure to properly install it onto the included waterproof housing before diving into water.





Contact Us

 (888) 466-9222 (US)

 cs@akasotech.com

 www.akasotech.com

For any inquiries about AKASO products, please feel free to contact us. We will respond within 24 hours.

